

Cable Glands

CW Cable Gland

- Application:** Suitable for indoor and outdoor use.
Used when waterproof seal is required.
- Contents:** Gland kits UCW20 to UCW32 contain: 2 brass glands, 2 PVC shrouds, 2 steel lock rings, 2 earth tags.
Gland kits UCW40 to UCW75 contain: 1 brass gland, 1 PVC shroud, 1 steel lock ring, 1 earth tag.
- Operating temperature:** -80°C to +300°C.

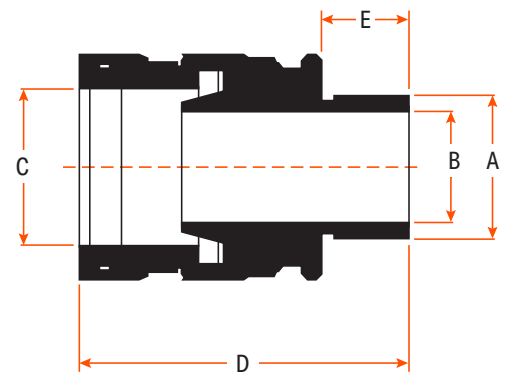
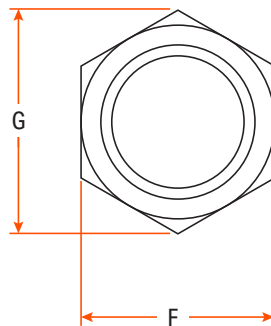

Item No.	Standard Thread Entry (mm)	Cable Bedding Dia. (mm)	Overall Cable Dia. (mm)	Overall Length (mm)	Thread Length (mm)	Hex. Size Across Flat (mm)	Hex. Size Across Corner (mm)	Pack Quantity
	A	B	C	D	E	F	G	
UCW20S	M20	12.5	15.0	42.0	10	21.8	23.8	2
UCW25	M25	20.7	27.0	44.0	10	36.0	39.0	2
UCW32	M32	27.0	32.5	46.0	10	43.5	48.8	2